

## Cyrus Street, London, EC1V

Fantastic two double bedroom apartment located on the second floor in this attractive purpose-built property.

Benefits include an open-plan kitchen and south-facing reception room filled with natural light, two double bedrooms, family bathroom and WC. The property further benefits from exceptional storage throughout including an additional storage closet.

The property is very well-presented and offers comfortable living and true city convenience from its location in the heart of London. On entering, the large living room draws you in and is perfect for entertaining. The stylish kitchen arrangement allows for lots of natural light and semi-open plan living. The bedrooms are also bright and spacious and particularly quiet with further cupboard space.

Also includes double glazing throughout, gas central heating and direct access to a balcony/terrace.

The Triangle can be found in central Clerkenwell and is conveniently located for all the local amenities on St Johns Street, Upper Street and Exmouth Market. Transport links can be found at Angel, Kings Cross, Old Street and Farringdon stations.

The flat is incredibly well connected with easy access to London's public transport network: Angel (Northern), Barbican (Circle, Hammersmith & City, Metropolitan TFL lines) and Farringdon (TFL, National Rail & the Elizabeth Line to Heathrow) are all moments from the flat as well as Old Street stations (National Rail & Northern line TFL).

- Rare Opportunity to Purchase
- Fantastic Two Bedroom Flat
- Superb Clerkenwell Location
- Excellent Storage Throughout
- Second Floor Terrace/Balcony Access

**Asking price £600,000**

# CYRUS STREET, EC1V

Approx. Gross Internal Floor Area

763 Sq. ft/70.92 Sq. m

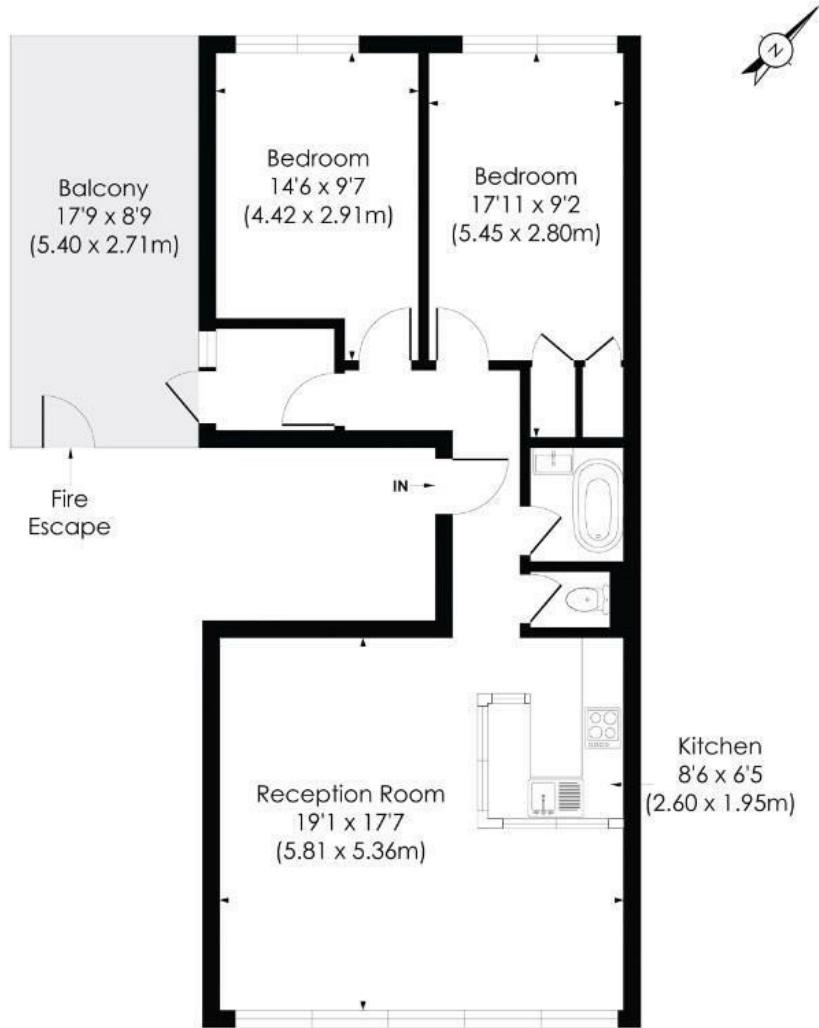

SECOND FLOOR

© Pixangle Property Marketing Ltd, info@pixangle.com Tel: 0208 870 2118



This floor plan has been prepared for the purpose of illustration only in accordance with the latest RICS code of measuring practice and is not to scale. All measurements and areas are approximate and whilst every effort has been made to ensure the accuracy of the plan contained here, no responsibility is taken for any error, omission or misstatement.



| Energy Efficiency Rating                    |                    | Current | Potential |
|---|--------------------|---------|-----------|
| Very energy efficient - lower running costs | (92 plus) <b>A</b> |         |           |
| (81-91) <b>B</b>                            |                    |         |           |
| (69-80) <b>C</b>                            |                    |         |           |
| (55-68) <b>D</b>                            |                    |         |           |
| (39-54) <b>E</b>                            |                    |         |           |
| (21-38) <b>F</b>                            |                    |         |           |
| (1-20) <b>G</b>                             |                    |         |           |
| Not energy efficient - higher running costs |                    |         |           |
| England & Wales                             |                    | 72      | 78        |
| EU Directive 2002/91/EC                     |                    |         |           |

| Environmental Impact (CO <sub>2</sub> ) Rating                  |                    | Current | Potential |
|---|--------------------|---------|-----------|
| Very environmentally friendly - lower CO <sub>2</sub> emissions | (92 plus) <b>A</b> |         |           |
| (81-91) <b>B</b>  |                    |         |           |
| (69-80) <b>C</b>  |                    |         |           |
| (55-68) <b>D</b>  |                    |         |           |
| (39-54) <b>E</b>  |                    |         |           |
| (21-38) <b>F</b>  |                    |         |           |
| (1-20) <b>G</b>   |                    |         |           |
| Not environmentally friendly - higher CO <sub>2</sub> emissions |                    |         |           |
| England & Wales   |                    |         |           |
| EU Directive 2002/91/EC   |                    |         |           |

3rd Floor, 6-8 Bonhill Street, City of London, EC2A 4BX  
 Tel: 02080040100 | Email: hereforyou@fineliving.life  
 www.fineliving.life